



Key Dates for Parents/Carers

Monday 16th – Friday 20th November: Anti-Bullying Week

Important Information

Dear Parents & Carers,

We have had a great first week back from Half Term, lots going on! I would to convey the following messages to you for your attention...

Litter picking

We started the new term off on a really good note...when I went to thank the litter monitors, they informed me that 'there is no litter to pick' – FANTASTIC! When we all do our bit, our bit gets easier for us all. Thank you!

Drop off and pick up

A BIG thank you to all Parents for co-operating and bearing with us today. The pick-up process was a lot smoother this time round so thank you very much!

As you are aware, we sent letters home to all Parents regarding the new home time exit procedure detailing the new timings, exit gates and queueing. Please familiarise yourselves with the map below so that we can all work together to ensure a smooth transition for the children and Parents after School.

Morning drop-off:

8.30am - 8.45am - KS1 come in through **GATE D**

8.30am - 8.45am - KS2 come in through **GATE C**

Parents are not allowed on the Playground when dropping children off

Afternoon pick-up:

3.00 - 3.15pm - Reception children finish

3.15 - 3.30pm - Nursery children finish

3.00pm – Children who walk home alone finish & exit through **GATE C**

3.00pm – Key Stage 1 children finish & exit through **GATE C** (If KS1 children have siblings in KS2 they can collect them & leave together through **GATE C**)

3.20pm – Key Stage 2 children finish & exit through **GATE C**

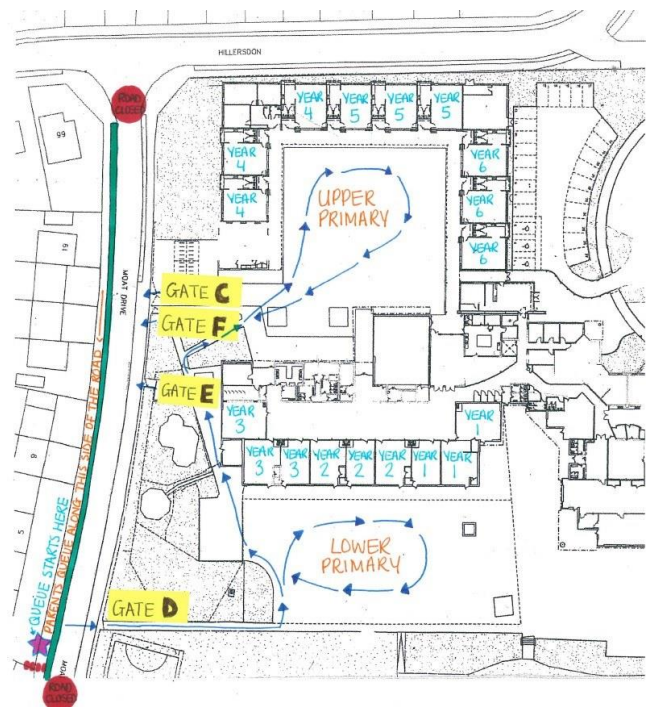



WEXHAM COURT
PRIMARY SCHOOL



Parents are not allowed to enter before 3.20pm

Parents must queue along the residents' side of Moat drive (highlighted in green), not along the school side road. This is to make sure that there is no crossover thus allowing people to keep moving.

Diwali

It is Diwali on Saturday 14th November! Diwali is the Indian festival of lights, usually lasting five days and celebrated during the Hindu Lunisolar month Kartika. One of the most popular festivals of Hinduism, Diwali symbolizes the spiritual victory of light over darkness, good over evil, and knowledge over ignorance. So please speak to your children about the festival. We wish those who are celebrating a happy and safe celebration!

Many thanks and a Happy Diwali 😊

Many thanks,
Navroop Mehat



Awards & Honours

STARS OF THE WEEK

	Nursery	Reception	Year 1	Year 2	Year 3	Year 4	Year 5	Year 6
Morning		England Roman	Australia Maira	Canada Nadia	Ecuador Hailey	Mozambique Max	Hungary Aleena	Nepal Engalpreet
Afternoon		Wales Rafay	Tonga Mehran	Jamaica Abhijash	Peru Jaiveer	Tanzania Haleema	France Aiesha	China Vansh
	Ayva	Scotland Ayaan	Fiji Mesum	Mexico Ibrahim	Chile Haleema	Morocco Fiza	Italy Freya	Thailand Thomas

MATHLETICS

1st PLACE	Australia	
	Mozambique	2nd PLACE
3rd PLACE	Tanzania	
	Peru	LET'S IMPROVE



HOUSE POINTS THIS WEEK

House Name	Points	Ranking
Copper Beech	243	2 nd
Horse Chestnut	222	4 th
Majestic Oak	238	3 rd
Sycamore	262	1 st

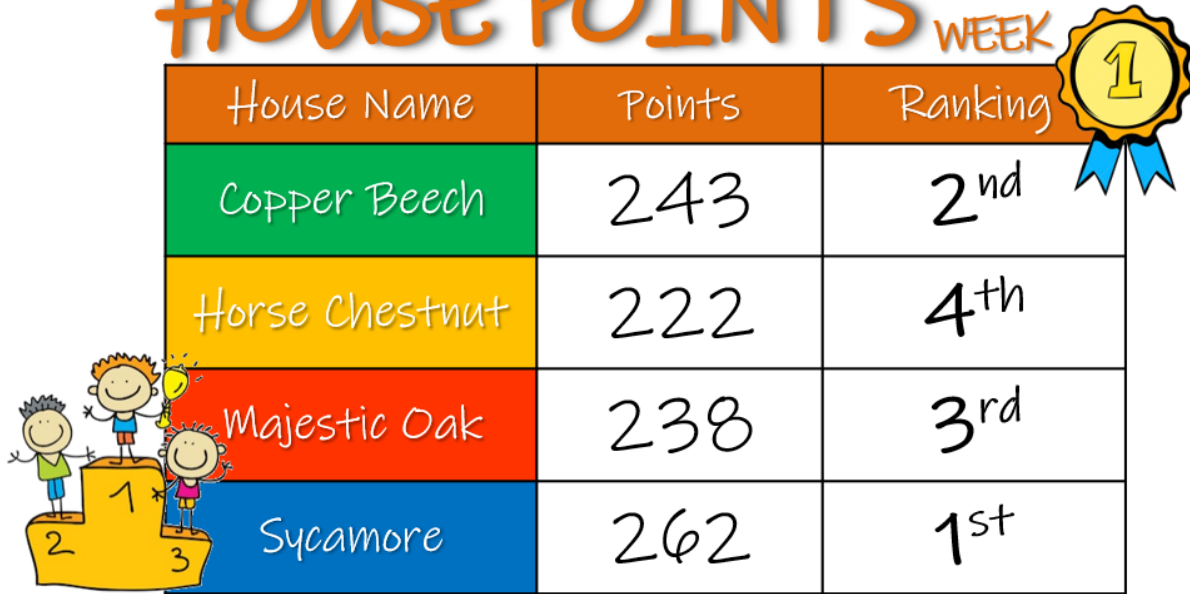

Key Messages & Reminders

Just so you don't forget...

Uniform Checks

PE uniform should be in line with the uniform list and checks will be taking place. Please ensure that your child/children are wearing the correct PE Kit...please refer to the uniform check list below to see what the correct PE Kit is for children.

PE Kit

Plain white T-shirt or polo shirt. Blue shorts, tracksuit bottoms or leggings. School Jumper – strictly no hoodies. Plimsolls or trainers.

Ventilation

A gentle reminder that due to the COVID-19 guidelines, we have to ensure classrooms are well ventilated - this means we have windows opened throughout the day. As the weather is cooling down, it is imperative that your child is wearing his/her jumper and a coat to School.



Walk to School

Great News! Walk to School is back. We ask that you encourage your child/children to walk to school. Not only will this help avoid congestion and environmental damage but your child will be rewarded with a cool sticker. It's also a great opportunity for you to do your daily mile walk 😊

Slough Music Service

Would you like to learn an instrument? Lessons with Slough music service are available in school or online. Discounted fees are available. For more information go to www.sloughmusicservice.co.uk. They have a variety of instruments in school that can be loaned to students including flutes, saxophone, recorders and clarinets and Slough music service can loan a wide variety of other instruments including violins, cellos and guitars.



SLOUGH MUSIC SERVICE

- Learn to play an instrument
- Join a band, orchestra or choir
- Take part in a course, residential or tour

CHECK US OUT!
www.sloughmusicservice.co.uk
or give us a call on 01753 759614

/sloughmusic @sloughmusic



Supported using public funding by
 ARTS COUNCIL ENGLAND



*From all the staff here at Wexham Court Primary School,
we hope you have a great week ahead!*